

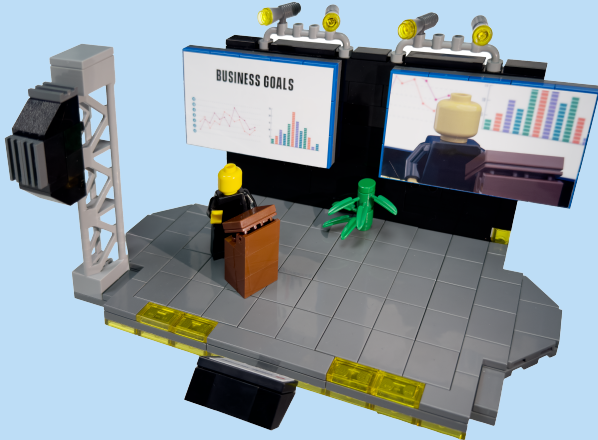

Ages
4-99
General Session Stage



Custom LEGO® Kit

Staging Solutions pre-visualizes, pre-builds and pre-tests all event assets and creative content before they leave our shop. Through engineering studies, mockups, rehearsals, content proofing and programming, we provide predictable and dependable execution, and minimize surprises. Our commitment to precision drives every outcome.

Enclosed is our final gift to you this month, one that embodies logic and reasoning, playfulness and imagination: A custom-designed LEGO® set celebrating the work we do. We are inspired by the precision of LEGO® products, and by their company spirit: Only the best is good enough.

We've logged hundreds, nay thousands, of hours assembling LEGO® bricks, and they fit perfectly every time. Call us when you need quality and precision, and you're ready to have some fun.

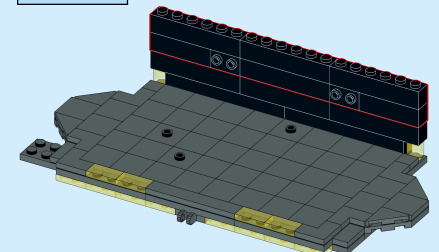
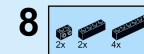
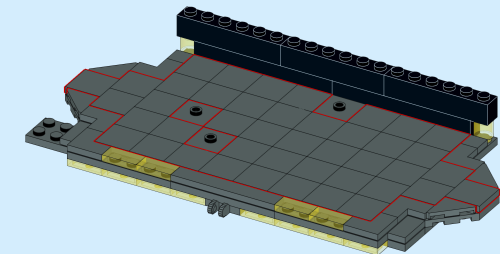
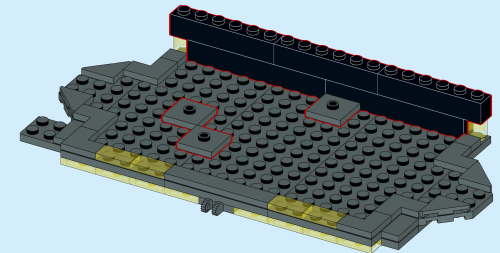
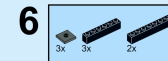
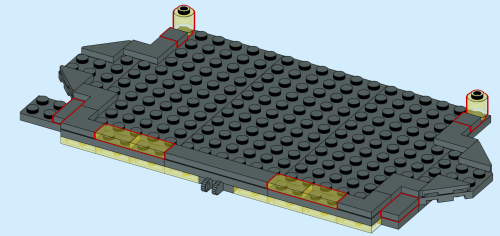
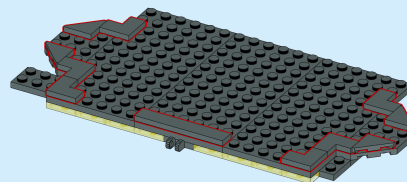
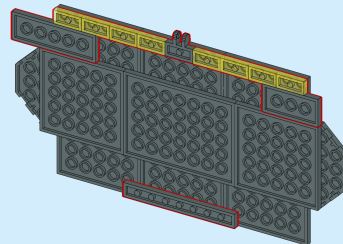
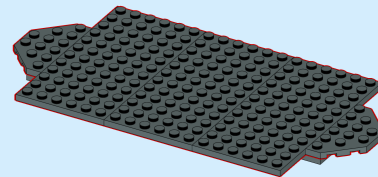
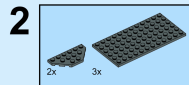
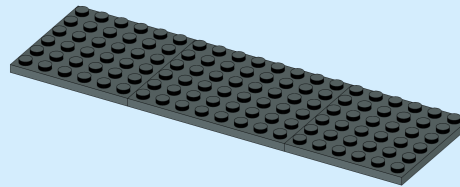
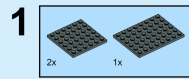

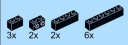
9 

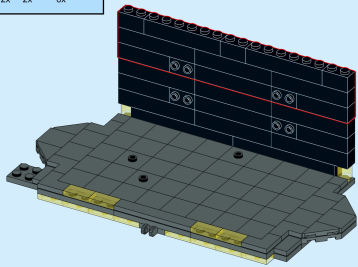

10 

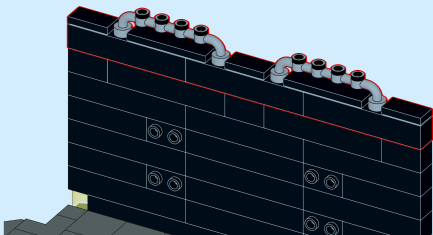

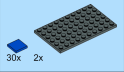
11 

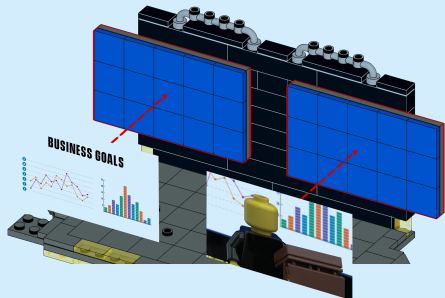
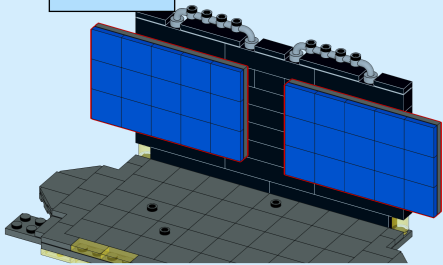

12 

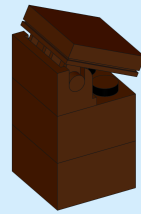

13 

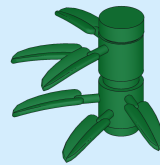

14

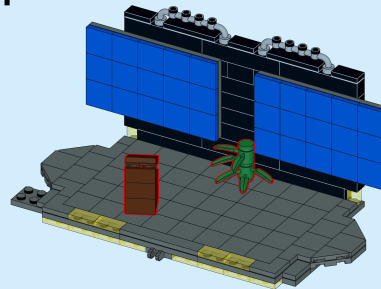

15 

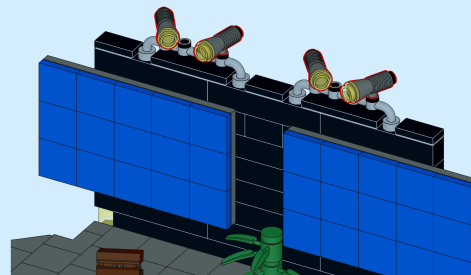

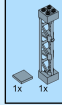
16 

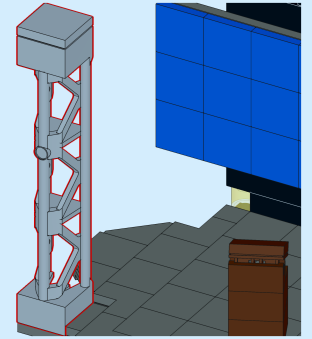

17 

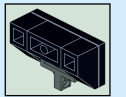
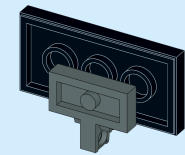

18 

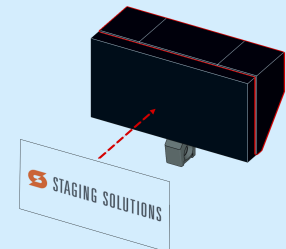
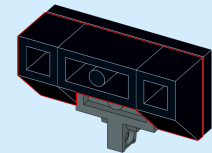

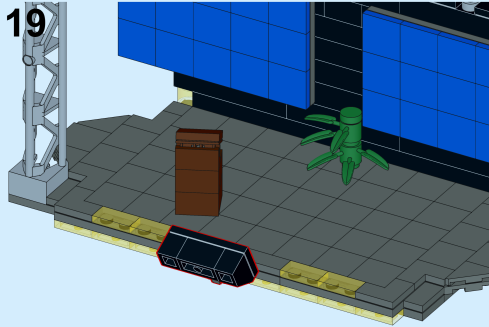

20

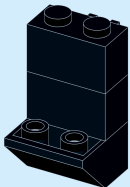
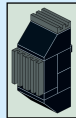

21

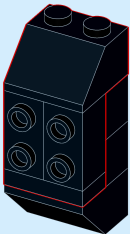

22

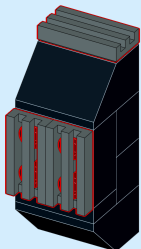

23

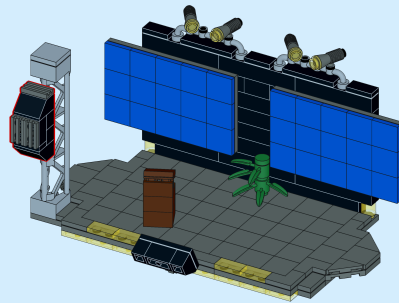

24



25

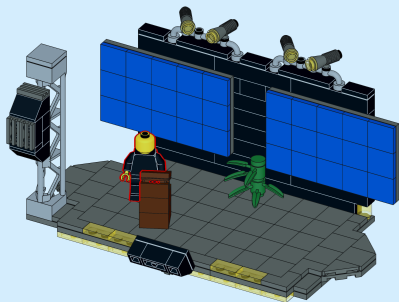

As an extra step toward sustainability, each brick for your set was sourced from available used sources from across the U.S.

Every effort has been made to ensure that each piece is clean and free from major defects, but it is a part of their charm that you know they have been lovingly built with prior to being assembled into this set.

In the unlikely event you do find a piece that you feel is sub-standard or is missing, please contact us for a free replacement.

For customer support, contact:

Tim Thomson
tim@stagingsolutions.com
(713) 816-1267

Enjoy!